

Humboldt Bay

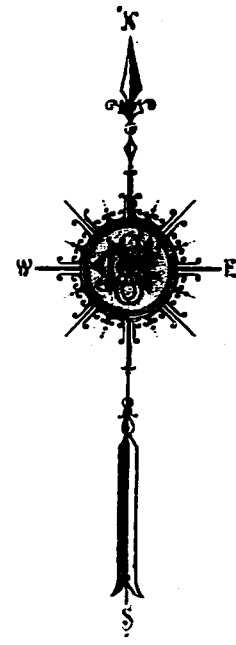

NO EXPOSURE  
EUREKA CAL.  
74  
15,000 GAL. CRUDE OIL TANK 25' HIGH  
27 1/2' ALONG OIL TANK 25' HIGH

UNION OIL CO'S. PLANT

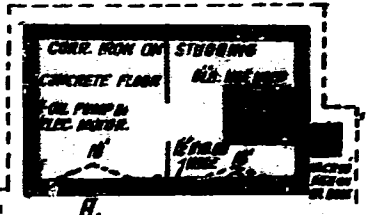

PLANKED PLATFORM 6' ABOVE MARSH  
2" W.P. CORR. WITH CITY MAINS

702

170' 100' BEYOND

LUMBER IN TRANSIT ON WHARF

IRREGULAR LUMBER PILES ON PLANKED PLATFORM 2' ABOVE REFUSE FILLED LAND

260

LUMBER PILES AVERAGE 16' HIGH

Log Pond

BAYSIDE LUMBER CO.

CAPACITY OF SAW MILL, 60,000 FT. IN 10 HOURS  
CAPACITY OF SHINGLE MILL, 25,000 IN 10 HOURS  
TWO NIGHT & SUNDAY WATERMEN, ONE IN MILL & ONE IN LUMBER YARD, BOTH CARRY MICHIGAN CLOCKS 11 STATIONS EACH, HOURLY ROUNDS, POWER: STEAM FUEL: REFUSE, LIGHTS: ELECTRIC, GRINNELL AUTO SPRINKLERS, WET PIPE IN BLDGS. AS SHOWN, 504 FEET 8" X 10".  
PRIMARY SOURCE OF SUPPLY - CITY WATER THROUGH 6" MAIN  
SECONDARY SOURCE OF SUPPLY - SALT WATER FROM BAY BY DOWN STEAM PUMP 16" X 3" X 12" CAPACITY 150 GAL. PER MIN. HYDRANTS & HOSE AS SHOWN.  
ONE HOSE CART 300' 2" HOSE.

REFUSE FIRE  
12' CORR. IRON FENCE AROUND

1129

WESTERN STATES GAS & ELECTRIC CO.

BOILER NO. 2  
IN OPERATION DAY & NIGHT  
POWER: STEAM, FUEL: OIL, LIGHTS: ELECTRIC, CITY & WELL WATER.  
STEEL CRANE ON TR. ON GRADING COPY DETAILS.  
2-5,000 GAL. METAL OIL TANKS ON OIL & SALT WATER UNDER TRUSSELS.

RAILROAD

WESTERN STATES GAS & ELECTRIC CO.  
10,000 GAL. CRUDE OIL TANK 25' HIGH.  
6,000 GAL. CRUDE OIL TANK 25' HIGH.

1130

Scale of Feet. 0 50 100 150

Copyright 1920 by the Sanborn Map Co.

LOW MARSH LAND - NO EXPOSURE.

PACIFIC AV.

NO EXPOSURE